

# Salvia Collection and Packaging Instruction Sheet

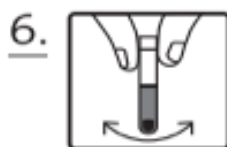

St Mary's  
University  
Twickenham  
London

## Saliva Collection:

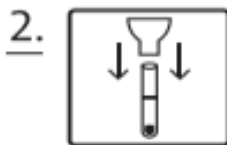
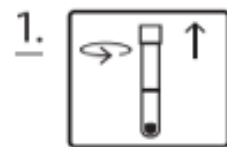

1. Unscrew lid from tube and put it aside for further use.

2. Insert funnel into tube tightly.

3. Rub cheeks against teeth intensely for 30 sec.

4. Collect saliva to indicated fill level; avoid making and measuring air bubbles.

5. Remove and discard the funnel. Screw lid tightly onto the tube again.

6. Gently shake tube for 15 sec to dissolve white reagent.

7. Store the tube upright for 2-20 min with occasional shaking until Saliva Gene reagent is dissolved. Some cloudy material may occur during this process. This does not interfere with stabilization.

8. The DNA in SalivaGene stabilized samples is stable for 1 year at room temperature within the expiry date.

## Packaging:

Place saliva vial into the Safebox provided. Packaging and sealing is **detailed on the following page**. Please **follow the instructions carefully**.



### Step 1:

1. Place sample in the leak proof container provided.

>1



### Step 2:

1. Wrap container in absorbent material.

>2



### Step 3:

1. Place the whole package into the clear plastic compartment.
2. Please place any paperwork required into the other compartment.
  - a. Consent form if not emailed.
  - b. Questionnaire if not completed online.

>3



### Step 4:

1. Ensure everything you need to send is inside the Safebox before sealing. **You cannot reopen the Safebox!**

>4



### Step 5:

1. Remove the cardboard separator from the underside of the lid and dispose in any bin.

>5



**Step 6:**

1. Place the lid over the top of the container and firmly press shut.

&gt;6

**Step 7:**

1. Peel the outer-backing from the self-adhesive label.
2. Wrap around Safebox.

&gt;7

**Step 8:**

1. Your package is ready to go.
2. Double check the return address is as follows:

&gt;8

**Catherine Graham  
St Mary's University  
Waldegrave Rd,  
Twickenham  
TW1 4SX**

**Step 9:**

1. This First Class Safebox can be placed in any postbox or post office.

&gt;9

